

# MX Pay & Display Meters

## Key Features/Functions/Characteristics

	STANDARD	OPTION		STANDARD	OPTION
<b>Cabinet</b>			<b>Tickets</b>		
• 304 Colour powder coated stainless steel	✓		• Thermal – Natural Fibre	✓	
<b>Finish</b>			<b>User Interface</b>		
• Baked powder coat - selectable colors	✓		• LCD backlit display	✓	
• Baked powder coat – clear finish blasted stainless steel		✓	• Multi-language support	✓	
			• Tariff card	✓	
			• Upper & lower decals	✓	
<b>Dimensions</b>			<b>Payment Options</b>		
• Height: 1.50 Meter installed	✓		• Coins	✓	
• Width: 34cm – left to right	✓		• Tokens		✓
• Depth: 34cm – front to back	✓		• Credit card (real-time & batch back-up)	✓	
• Weight: 100kg – inc. battery & cashbox	✓		• Debit card		✓
			• Smart card (capability)1		✓
<b>Fixing</b>			<b>Phone payment</b>		✓
• 4 or 6 high-tensile anchor bolts, cast into concrete footing	✓				
• Flat or angled surface mount kit		✓	<b>Meter Configuration Management</b>		
			• Unit programming & updates	✓	
<b>Environment</b>			• Tariff programming	✓	
• Temperature range: -25°C to +55° C	✓		• Special event programming	✓	
• Relative Humidity: up to 97%	✓		• Remote programming via wireless communication	✓	
<b>Power Supply</b>			<b>Management System</b>		
• Rechargeable lead-acid with solar panel	✓		• Hosted management system	✓	
• Mains		✓	• Wireless real-time communication	✓	
			• Secured system & information access	✓	
<b>Communications</b>			• Automated alarms	✓	
• Batched Back-up (PCI)	✓		• Management reporting	✓	
• GPRS (PCI)	✓		• Performance reporting	✓	
			• Revenue reporting	✓	
<b>Security</b>			• Data import & export capability	✓	
• Abloy high security locks	✓		• Relational DBMS (MS-SQL)	✓	
• Medeco electronic locks (vault)	✓	✓	• Database backup/recovery support	✓	
• Anti-Probe Device for coin chute	✓		• Ongoing system maintenance & support	✓	
• Separate access for service & cashbox vault	✓				
• Cashbox auto-locked before extraction	✓				
• Cashbox audit memory	✓				
<b>Printer</b>					
• Thermal	✓				

Built to Last, Designed to Evolve



# Duncan MX

## The ultimate digital pay & display parking solution

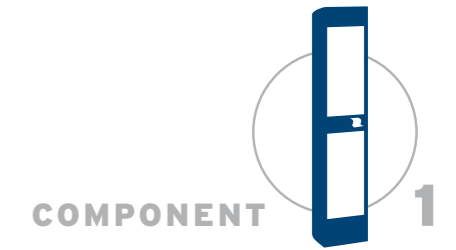

The Duncan MX Pay & Display Design incorporates the latest in parking design innovation.

MX's modular design ensures that maintenance and upgrades are cost-effective, easy to perform, and conform to OHS requirements.

The stainless steel housing is leader of its class, ensuring it remains the superior ticket issuing solution for the toughest environments imaginable.

In support of environmentally sustainable operations, each MX is fitted with an integrated solar panel. The solar panel is securely sandwiched between a 5mm acrylic lens and a 3mm galvanized steel plate, which separates the panel from the inside of the machine.

Optional wireless technology enables communication with AutoTRAX, the industry leading management suite and real-time transaction processing.

'Alternate payment functionality' provides the motorist with choice and convenience, and more means to pay for their parking. PCI compliance ensures transactions are safe and secure.

The MX is extremely resilient to vandalism and harsh environmental conditions. The cabinet is constructed from strong, corrosion-resistant, 304 stainless steel with additional powder coat protection.

A two-door vault system protects the internal components and cashbox and is sealed and tested for water ingress prior to release from manufacture, ensuring the highest quality.

Electronic components are conformably coated and each MX is fitted with multiple locks as a further security measure. A six point locking system and fully concealed hinges attach the two-door vault system to the cabinet.

The MX is designed to issue tickets in pay parking operations, but the meter can be adapted to issue tickets for other ventures such as boat marinas, golf courses, park use fees and gyms.

**“The MX is 100% Australian-made having been designed by Australians & manufactured in Australia. The MX design philosophy was simple, ‘Build to last – Design to evolve.’”**

### Programming & Technical Features

#### Unit Programming

The MX pay-and-display meter is highly configurable and fully programmable. Once a new configuration of program is created it is loaded onto the MX either wirelessly (via our AutoTRAX wireless management system) or on site. It is then automatically activated.

#### Programmable Time and Tariff Structures

Duncan meters contain a powerful microprocessor capable of managing any range of fixed, tiered or scaled parking tariff(s). This allows the meter to accommodate a wide variety of rate structures including:

- Variance by rate (i.e. flat rate structures, minimum payments required and fill ups);
- Variance by day or day of week (i.e. only pay during certain operating hours/days); and
- Variance by payment type (i.e. coin only, credit card only, mPARK or any combination).

Rate structures and configurations may be altered in a number of ways including:

- Remotely, via our AutoTRAX Wireless Management System;
- On site, via the meter's on-board keypad;
- On site, via a suitable handheld device; and
- Inserting a new Smart Media card.

#### Timer

The Duncan MX (via our AutoTRAX Wireless Management System) has its own accurate timer which is consistently synchronized to a central processing clock (on the server). The central processing clock of a computer is highly accurate and delivers automatic daylight savings updates for specific geographic territories. This process has the benefit of ensuring all equipment across the network is synchronized in real time. The digital processor real time clock chipset has a specification divergence of less than 30 seconds per month.



L to R: Intelligent cashbox; 6 point locking system; Service compartment.

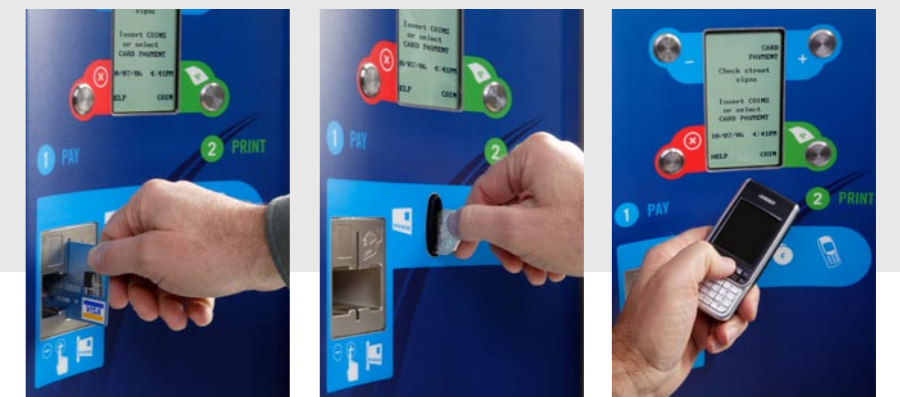

L to R: Credit card payments; Coin payments; Mobile phone payments.